

Order no.	Version	Appli- cation	PN	DN	Thread	PE pipe Ø mm	
3151	ISO Combination Service Valve DN 1" with 2" external thread for mounting onto saddle and 1½" external thread <u>only for ISO push-fit fitting No. 6221F (without ISO push-fit fitting)</u>	cold water other applications on request	16	1"	2" - 1½"		●
3150	ISO Combination Service Valve DN 1" with 2" external thread for mounting onto saddle and 1½" external thread <u>only for ISO push-fit fitting No. 6221F (complete with choice of ISO push-fit fitting)</u>			1"	2" - 1½"	25	●
						32	●
						40	●
						50	●
						63	●
6221F	ISO push-fit fitting with backing washer			1½"	25	●	
					32	●	
					40	●	
					50	●	
		63	●				

- one valve with 5 ISO push-fit fittings for PE pipes (pipe Ø 25/32/40/50/63 mm) - reduces stockkeeping
- a robust design of POM
- totally corrosion-free



ISO Combination Service Valve

Suitable handwheel: No. 7800
Suitable extension spindles: rigid No. 9101,
telescopic: No. 9601

Suitable surface boxes: rigid No. 1550 light duty,
rigid No. 1650 heavy duty,
telescopic: No. 1850, No. 1851K

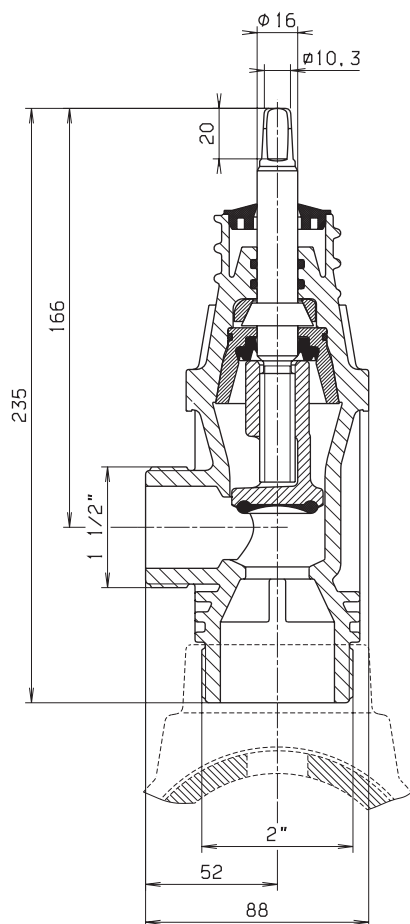

ISO Combination Service Valve DN 1"

with **2" external thread** EN 10226-1 for mounting onto saddle and **1 1/2" external thread** ISO 228 only for ISO push-fit fitting No. 6221F

Sealing system:

The contact between plug and body is friction free. Therefore no scuffing or abrasion on the plug.

Materials:

Body: POM
tensile strength 7000 N/cm²
Plug: CuZn39Pb3 (Ms 58)
Plug seal: of elastomer, suitable for potable water
Spindle: stainless steel 1.4021 (X20Cr13)

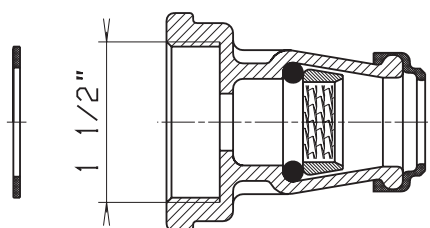

No. 6221F ISO push-fit fitting

of POM

internal thread 1 1/2" ISO 228

push-fit socket for PE pipes up to PN 16, pipe Ø 25/32/40/50/63 mm

The backing washer ("Aqua-rubber") eliminates sealing with hemp, therefore quick assembly!